

Lawn Road Play Area Improvements



Let us know what you think

Eastleigh Borough Council manages the Lawn Road/St Catherine's Road Play Area and we are keen to make some major improvements to make it a more attractive place for local children and their families.

.....

We're looking at concept design ideas to create a 'play area in a garden' and we're keen to get your views.

.....

This display outlines some proposals for possible improvements.

.....

Please give us your thoughts by emailing lawnroadplayarea@eastleigh.gov.uk or call 023 8068 8000 or by filling in one of our survey cards today.

.....

For more information visit eastleigh.gov.uk/lawnroad

How the play area is laid out at the moment



Existing Equipment



Concept

A play area in a garden



Beauty and nature

- Make a beautiful place to attract more children, parents and grandparents.
- Increase the time people spend there and their enjoyment of the space.

Improve the way different age groups are managed

Promote a free flow between age zones, whilst keeping age groups separated. Replace some of the railings with a more subtle, 'filtered' edge to the infants' play area. This would consist of mounds, planting and rocks. Parents would still be able to set boundaries for their younger children, but the existing play equipment would be in an attractive, stimulating and exciting setting. All roadside railings would be retained.

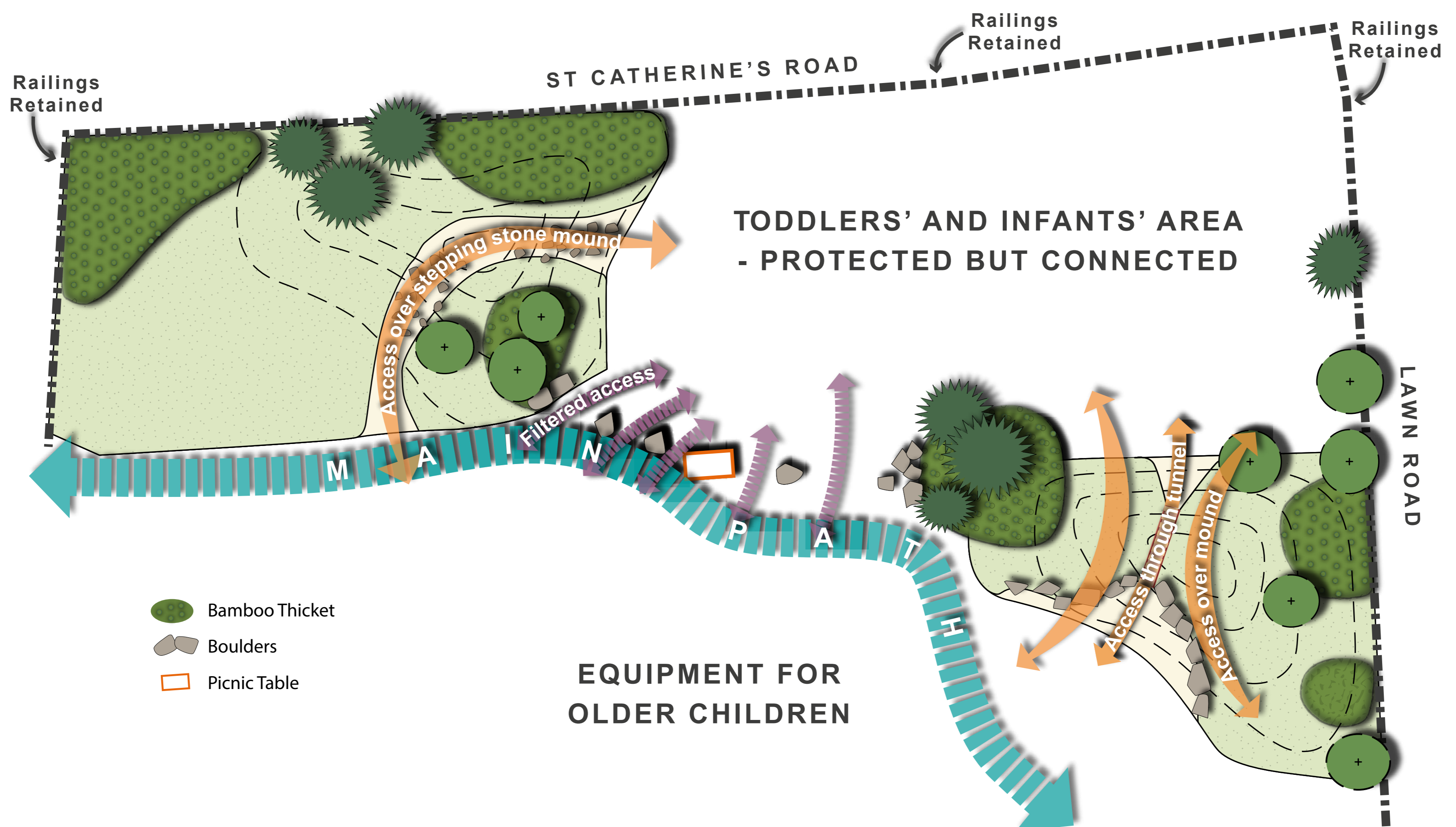

Concept

A play area in a garden

New setting

In recent years more recognition has been given to the importance of children being able to use their imagination in their play and at the same time, to be offered stimulating environments, contact with nature has real benefits for children's physical, mental and emotional health.

- Contact with plants and natural materials
- Mounds to run over; banks to provide/improve micro climate

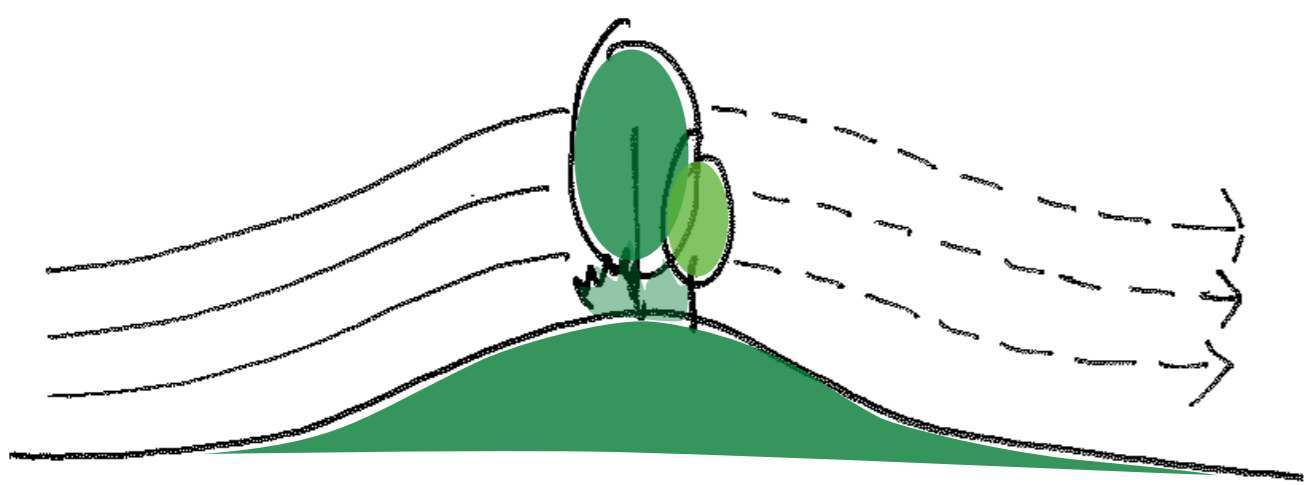

- Thickets of bamboo frame spaces and shape and reveal views, whilst providing sensory stimulation. Bamboo to brush past, squeeze through and animate the sound of the wind.



- Rock areas to climb over and stepped rocks for sitting and informal events.



Supplement the existing rocks: a collection together would provide much greater play value.

- Rocks to protect vulnerable corners and will double as play features.
- Thoughtfully chosen planting to entertain and inform; tropical, exotic, fun and funky.



Mitigate noise

- Relocate picnic tables to more central location;
- Provide mounds and tree and shrubs to dampen noise pollution.
- Move the centre of the play area towards the centre of the park to reduce noise to nearest residences.



Play equipment

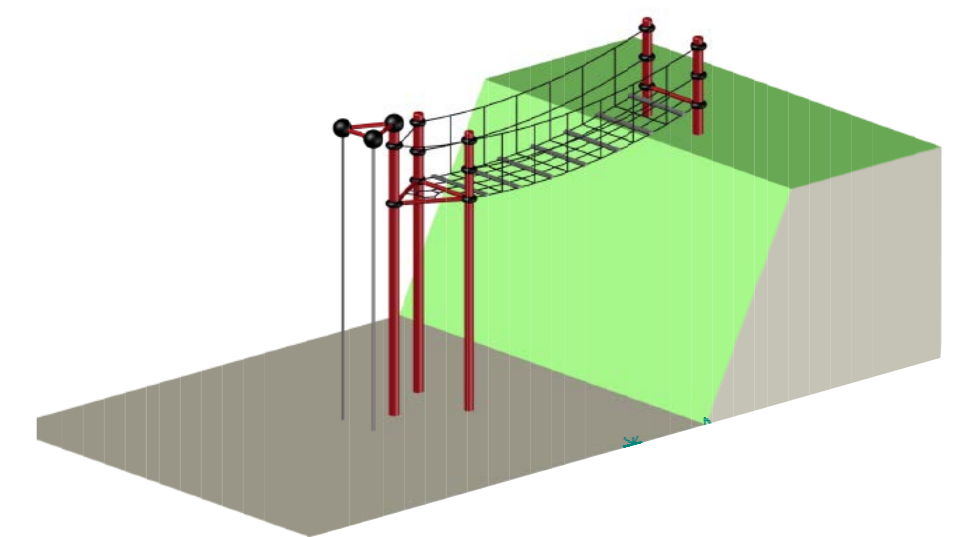

Restore and refurbish existing equipment and surfaces of value.

(See poster 2)

Remove and replace broken and poor value equipment. Introducing an embankment side gives the opportunity for a much higher and exciting slide than would be practical on a flat site.

The Fireman's Pole item is rather isolated and underused at present. However, it is very strongly built, so it is proposed to erect a net bridge/ramp from one of the new banks to increase interest and play value rather than remove it.

Funding will allow for the provision of some new items of play equipment and to enhance the setting of the equipment.

How the play area might be refurbished

This is a plan to show how the play area could be developed to look more attractive, with better facilities and an improved home for wildlife.

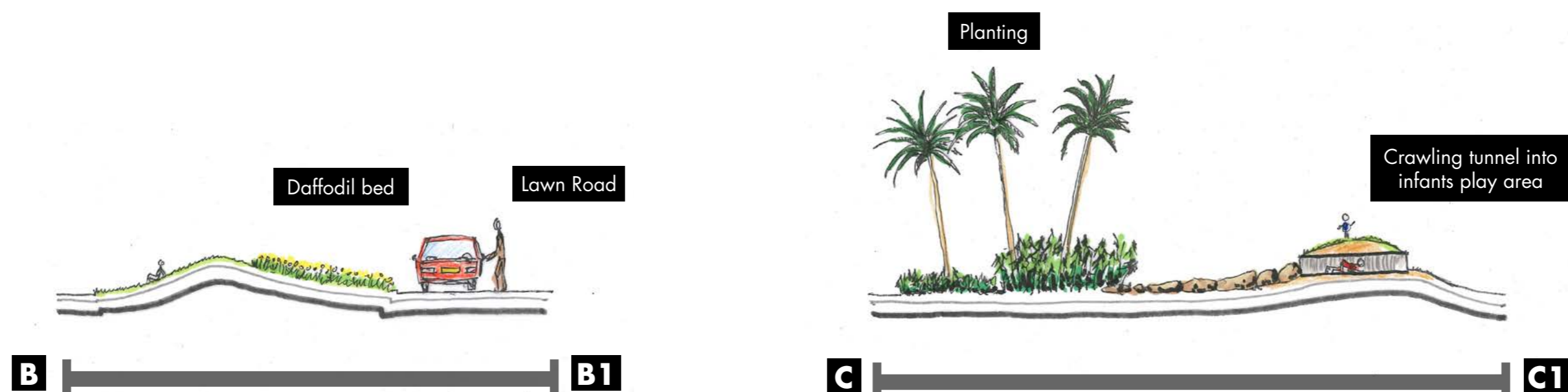
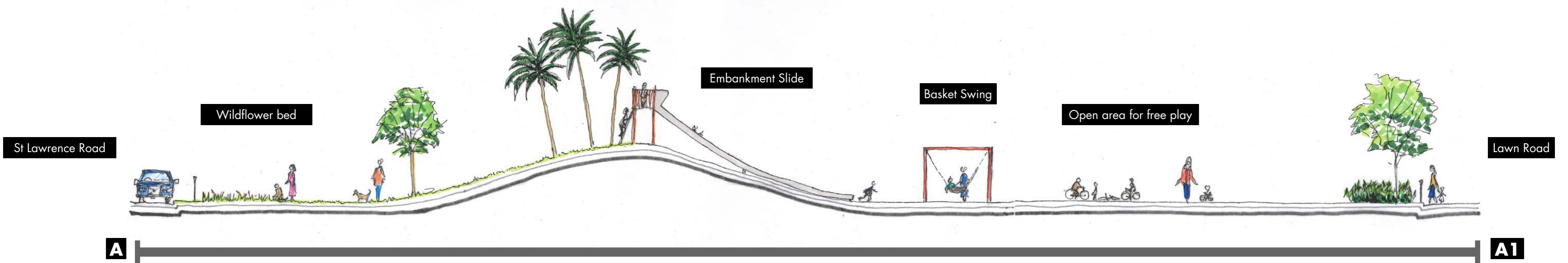
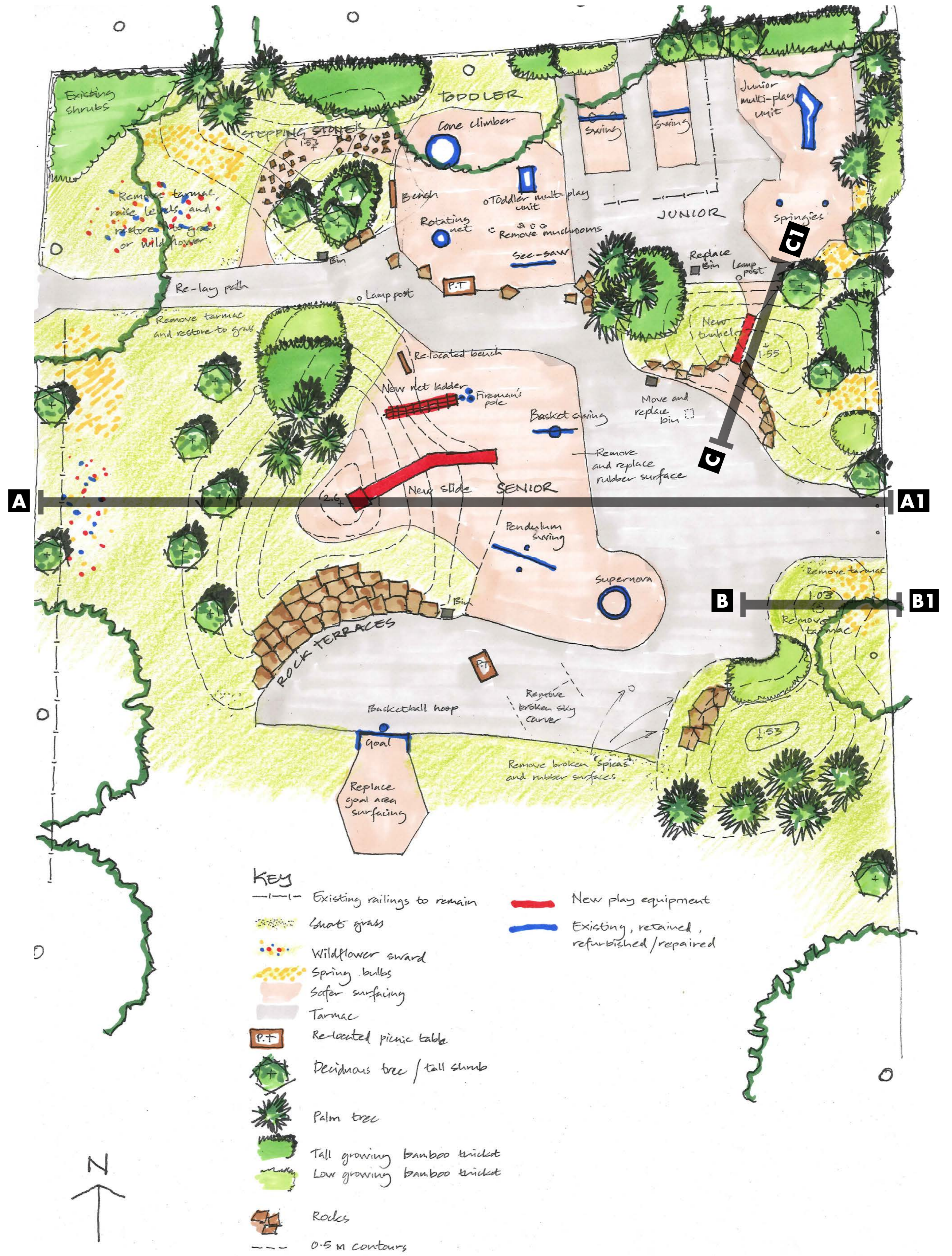

Thank you

Thank you for taking time to study this exhibition on the future of Lawn Road play area.

.....

Your views are important to us so please let us know what you think.
By emailing lawnroadplayarea@eastleigh.gov.uk, calling 023 8068 8000
or by filling in one of our survey sheets today.

.....

For more information and to stay up to date with the project visit eastleigh.gov.uk/lawnroad

.....

Implementation of all the suggested ideas will depend on acceptable tenders being received.

.....

The consultation period ends on Monday 18 November 2019, after
which the responses will be analysed and reported back to the Council

.....

Would you like to get involved?

Please Contact Pat Statham - pat.statham@yahoo.com / 07980 163922
(Chair of Boyatt Wood Community Trust) if you would be interested in joining a community
group to support the regeneration and on-going aftercare of Lawn Road.

.....

Please place your comments here: