

Eastleigh Borough Local Plan 2016-2036
Policies Map (Town Centre)

Key:

- Eastleigh Town Centre Boundary E3
- Northern Retail Anchor E3 (1a)
- Upper Market Street Block E3 (1a)
- Core Shopping Zone E3 (1c)
- Core Leisure Zone E3 (1c)
- Primary Shopping Zone E3 (1d)
- Secondary Shopping Zone E3 (1d)
- Eastleigh Urban Renaissance Quarter Boundary E4
- Residential, Office & Community Areas E4 (1a) & E4 (1e)
- Health & Education Area E4 (1b)
- Romsey Road Frontage E4 (1c)
- Leisure & Cultural Zone, Leigh Road E4 (1d)
- Shopping - Primary Frontage DM22
- Shopping - Secondary Frontage DM22

Policy Number notation

- S Strategic
- DM3 Development Management
- E6 Eastleigh

Notes:

- See also: New retail development (DM2)
- Community, leisure and cultural facilities (DM36)
- Public realm improvements in and adjoining Eastleigh town centre (E5)

For full details of the policies and proposals please see the Eastleigh Borough Local Plan 2016-2036 document

Scale 1:5,000

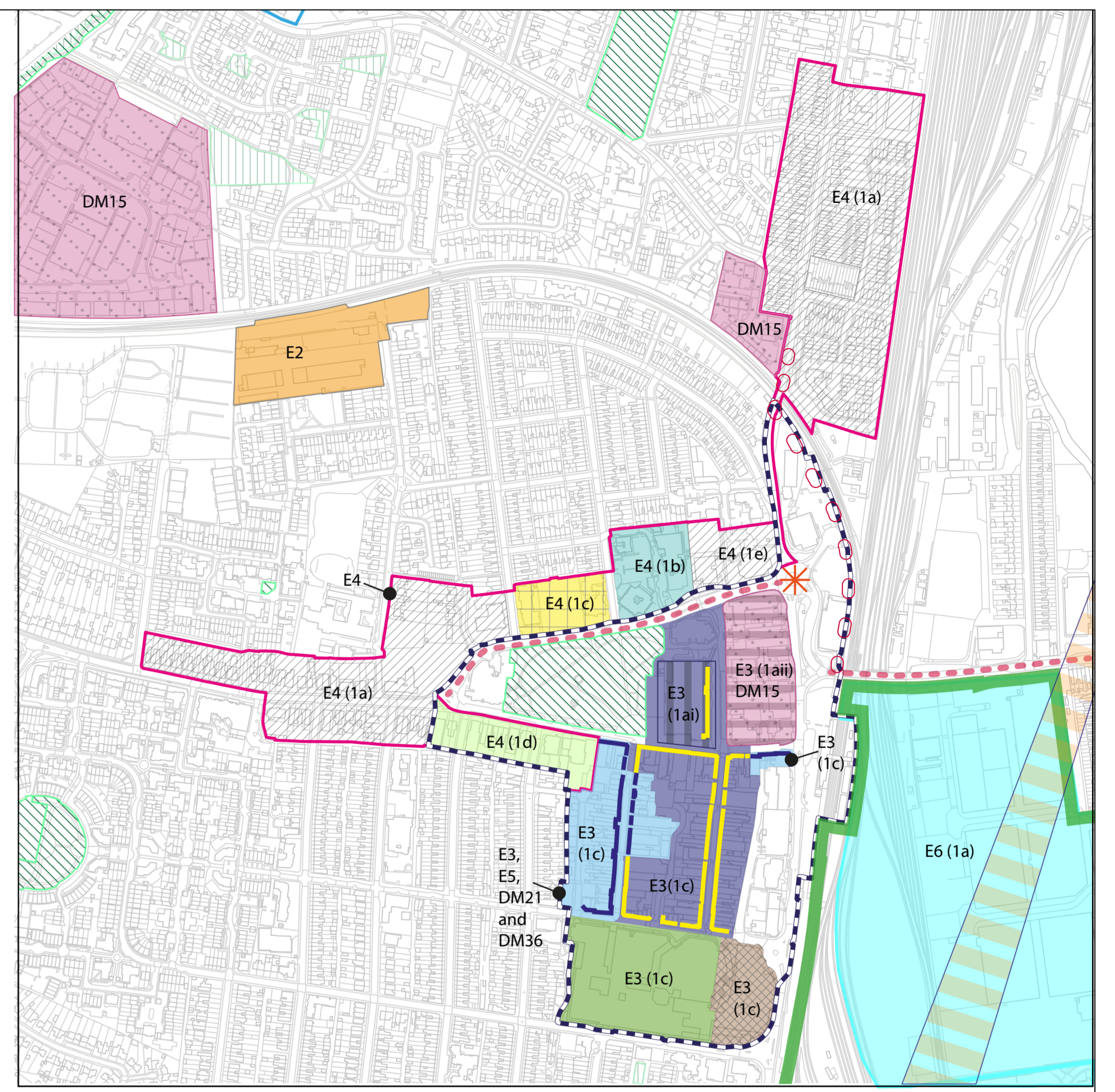

Eastleigh Borough Local Plan 2016-2036
Policies Map (North)

Key:

- Eastleigh Borough Boundary
- Urban Edge S2
- Countryside S5
- Settlement Gap S6
- HCC Minerals Safeguarding - see Hampshire Minerals & Waste Plan www.hants.gov.uk/mineralsandwaste
- International Nature Conservation Designation - SAC and/or SPA, Ramsar DM11
- National Nature Conservation Designation - SSSI DM11
- Local Nature Conservation Designation - SINCC and/or LNR (correct at December 2021) DM11
- Existing Recreation, Allotment and Open Space Facility DM32 & DM33
- Proposed Open Space (boundary identified) DM34
- Proposed Housing & Residential-Led Mixed Use Development Allocation S3
- Existing Employment DM15
- Proposed Employment S4
- Eastleigh Town, District and Local Centres and Neighbourhood Parades E3, DM21, DM22 & DM36
- Conservation Area DM12
- Ancient Monument DM12
- Strategic Footpath/Cycleway/Bridleway S12
- Proposed Strategic Footpath/Cycleway/Bridleway S12
- Proposed New Road S11 & AL1
- Long Term Safeguarded Road Route E6
- Junction Improvements DM13
- Eastleigh River Side (ERS) E6
- Former Civic Offices Site E1
- Southampton Airport E9
- Airport Public Safety Zone E9
- Aviary Estate E10
- Proposed Open Space HH1
- South of Stokewood Surgery B1

Policy Number notation

- S4 Strategic
- DM3 Development Management
- E5 Local Area - Eastleigh

Notes:

- For full details of the policies and proposals, please see the Eastleigh Borough Local Plan 2016-2036 document.

EASTLEIGH BOROUGH COUNCIL

Strategic Planning
 Eastleigh Borough Council
 Eastleigh House
 Upper Market Street
 Eastleigh
 Hampshire
 SO50 9PN
 Tel: 023 8068 8000
 Web: www.eastleigh.gov.uk