

Eastleigh Borough Local Plan 2016-2036
Policies Map (Town Centre)

Key:

- Eastleigh Town Centre Boundary E3
- Northern Retail Anchor E3 (1a)
- Upper Market Street Block E3 (1a)
- Core Shopping Zone E3 (1c)
- Core Leisure Zone E3 (1c)
- Primary Shopping Zone E3 (1d)
- Secondary Shopping Zone E3 (1d)
- Eastleigh Urban Renaissance Quarter Boundary E4
- Residential, Office & Community Areas E4 (1a)
- Health & Education Area E4 (1b)
- Romsey Road Frontage E4 (1c)
- Leisure & Cultural Zone, Leigh Road E4 (1d)
- Shopping - Primary Frontage DM22
- Shopping - Secondary Frontage DM22

Policy Number notation

Strategic: S
 DM3 Development Management
 E6 - Eastleigh

Notes:
 See also:
 New retail development (DM2)
 Community, leisure and cultural facilities (DM36)
 Public realm improvements in and adjoining Eastleigh town centre (E5)

For full details of the policies and proposals please see the Eastleigh Borough Local Plan 2016-2036 document

Scale 1:5,000

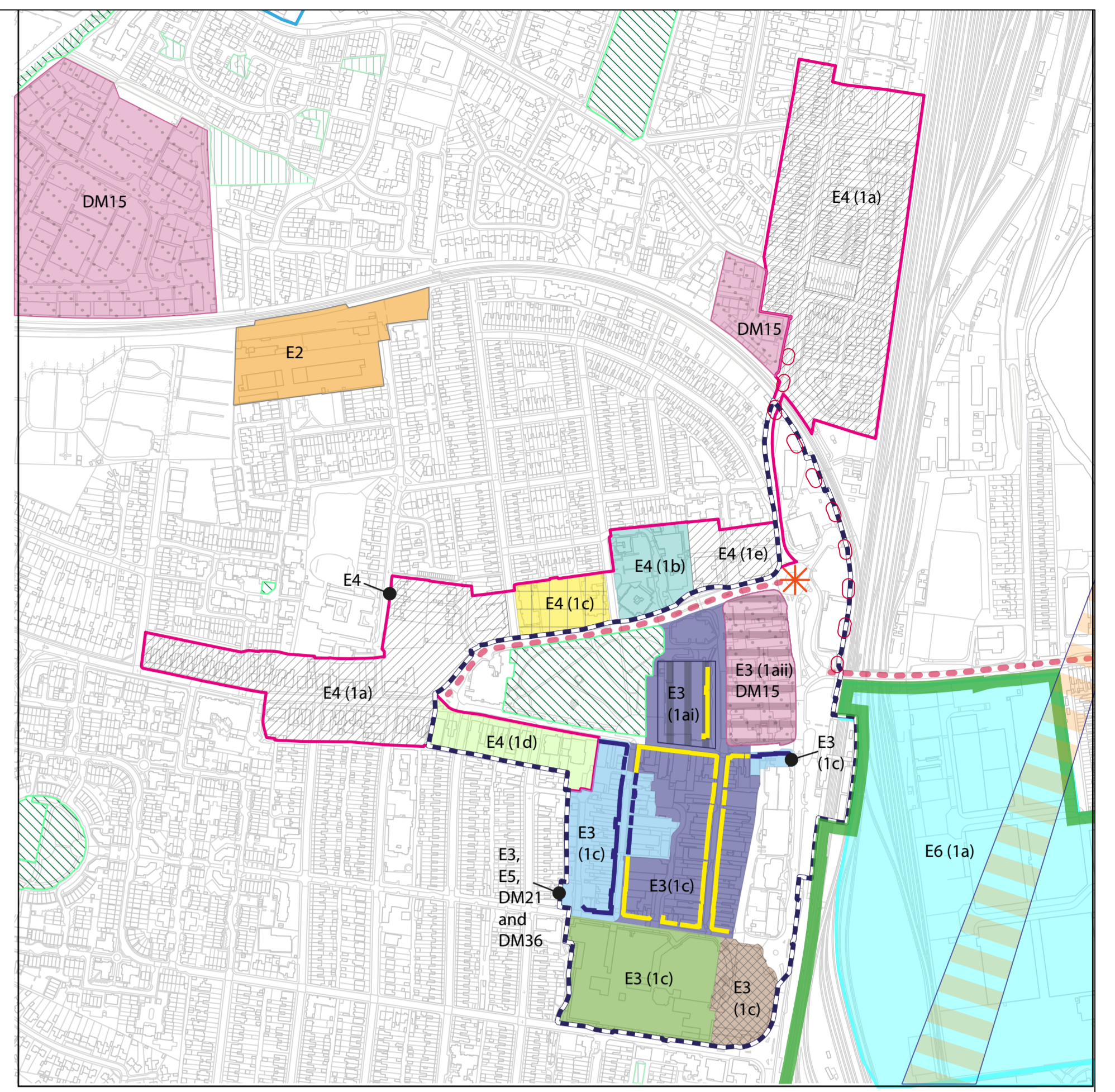

Eastleigh Borough Local Plan 2016-2036
Policies Map (North)

Key:

- Eastleigh Borough Boundary
- Urban Edge S2
- Countryside S5
- Settlement Gap S6
- MCC Minerals Safeguarding - see Hampshire Minerals & Waste Plan www.hants.gov.uk/mineralsandwaste
- International Nature Conservation Designation - SAC and/or SPA, Ramsar DM11
- National Nature Conservation Designation - SSSI DM11
- Local Nature Conservation Designation - SINCC and/or LNR (correct at December 2021) DM11
- Existing Recreation, Allotment and Open Space Facility DM32 & DM33
- Proposed Open Space (boundary identified) DM34
- Proposed Housing & Residential-Led Mixed Use Development Allocation S3
- Existing Employment DM15
- Proposed Employment S4
- Eastleigh Town, District and Local Centres and Neighbourhood Parades E3, DM21, DM22 & DM36
- Allocated Gypsy, Travellers and Travelling Showpeople Site and Gypsy Site DM31
- Conservation Area DM12
- Ancient Monument DM12
- Strategic Footpath/Cycleway/Bridleway S12
- Proposed Strategic Footpath/Cycleway/Bridleway S12
- Proposed New Road S11 & AL1
- Long Term Safeguarded Road Route E6
- Junction Improvements DM13
- Eastleigh River Side (ERS) E6
- Former Civic Offices Site E1
- Southampton Airport E9
- Airport Public Safety Zone E9
- Aviary Estate E10
- Proposed Open Space HH1
- South of Stokewood Surgery B11

Policy Number notation

Strategic: S
 DM3 Development Management
 E6 - Local Area - Eastleigh

Notes:
 For full details of the policies and proposals, please see the Eastleigh Borough Local Plan 2016-2036 document.

EASTLEIGH BOROUGH COUNCIL
 Strategic Planning
 Eastleigh Borough Council
 Eastleigh House
 Upper Market Street
 Eastleigh
 Hampshire
 SO50 9PN
 Tel: 023 8068 8000
 Web: www.eastleigh.gov.uk